

Produced by the USDA Forest Service.
North American Datum of 1983 (NAD 83).
Projection and 1,000-meter ties: Universal Transverse Mercator, zone 17.

Full Revision of Forest Service lands 2022
Updates to Transportation 2022
Updates to Boundaries 2022

Non-National Forest System lands within the National Forest as of 2022.
Inholdings may exist in other National or State reservations.

This is not a legal document. Public lands are subject to change and leasing, and may have access restrictions. Not all roads and trails on this map are open to motor vehicle use. Check with appropriate officials and obtain appropriate regulatory maps and information. Obtain permission before entering private lands.

This map product uses the most current data available in the USDA Forest Service cartographic database. Modifications, updates, and corrections may be made at any time. Print quality is determined by the output device used when producing a hardcopy product.

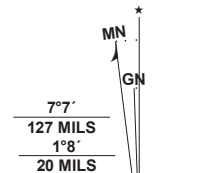

U.S. National Grid	
100,000 - m Square ID	
LD	00
LC	00
Grid Zone Designation 17S	



MOTOR VEHICLE USE MAP (MVUM)
The MVUM is a legal enforceable document that identifies the roads, trails, and areas where motor vehicle use is allowed in a Forest Service administrative unit or ranger district. MVUMs are reissued each year. It is the responsibility of motor vehicle users to acquire the current MVUM. MVUMs are available FREE at Forest Service offices and at www.fs.fed.us/recreation/programs/ohv/ohv_maps.shtml



Adjoining Quadrangles
Lawrence
Stockdale
Petersburg
New Boston
Minford
South Webster
Portsmouth
Wheelersburg
Pedro

HIGHWAYS AND ROADS			
Interstate	5	Highway	1
U.S.	105	Road, Unspecified	1
State	78	Road, Paved	1
County	6	Road, Gravel	1
National Forest, suitable for passenger cars	105	Road, Dirt	1
National Forest, suitable for high clearance vehicles	80	Unimproved	1
National Forest Trail	384	Road, Closed	1
		Trail	1
		Game Barrier	1
		Check with local Forest Service unit for current travel conditions and restrictions	

This product generated and downloaded on 1/10/2023

USDA is an equal opportunity provider, employer, and lender